

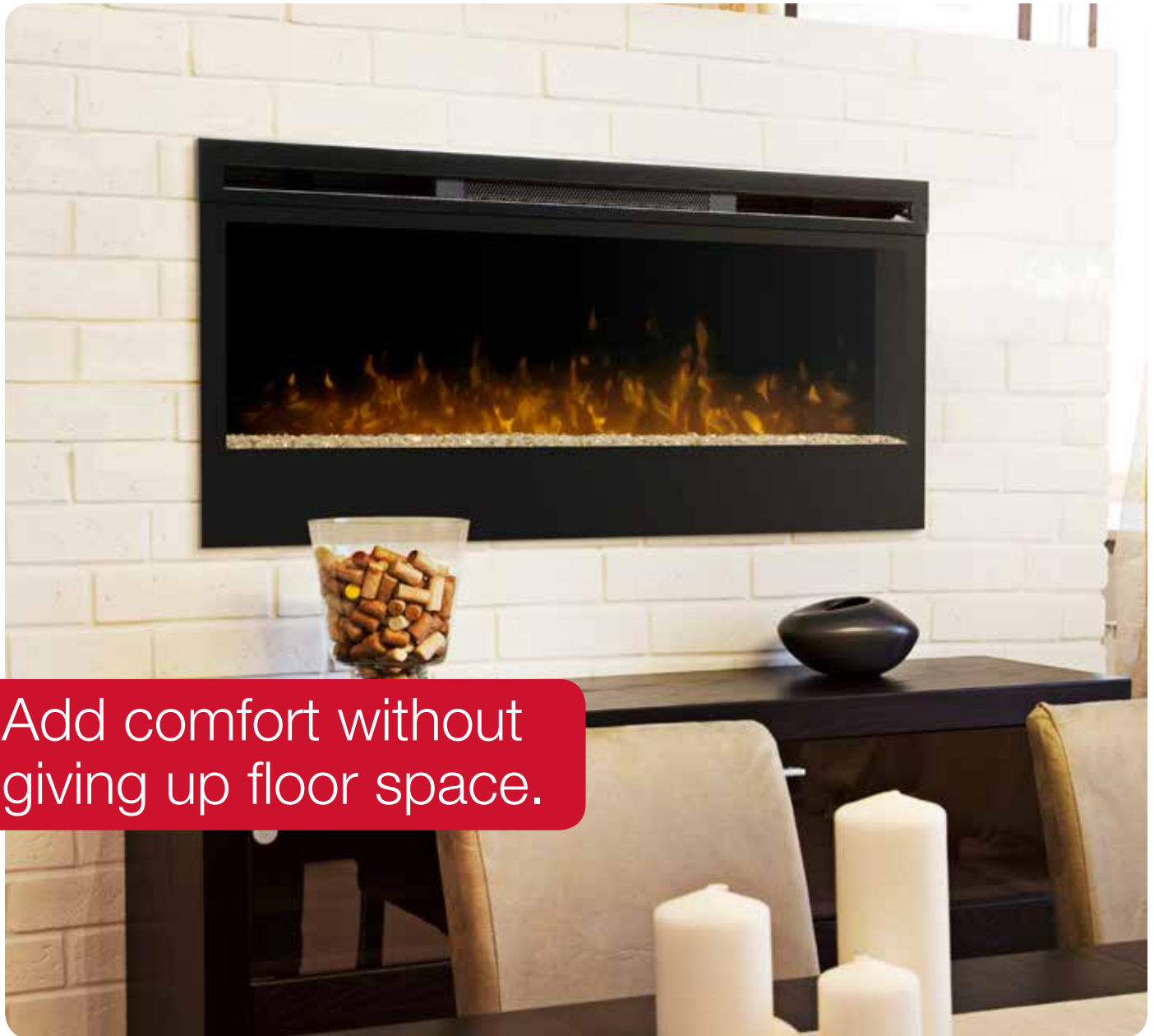

Synergy

Wall-mount Electric Fireplace

BLF50



Add comfort without giving up floor space.

The 50" linear fireplace features realistic patented LED flame that dances on the crushed and silvered glass pieces, adding comfort, ambiance and beauty to any space. The heat that warms the room comes from the front of the fireplace allowing the sleek and elegant design to be installed snug to the wall.



Synergy

Wall-mount Electric Fireplace

BLF50

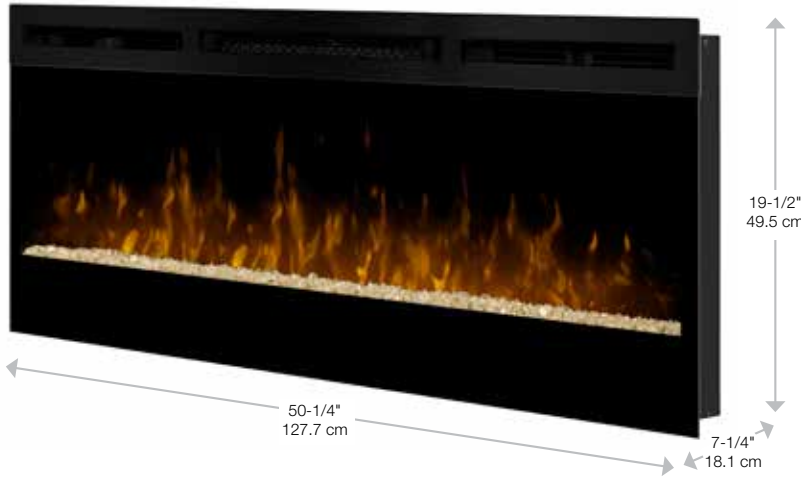

Accessories



Cohesion Trim - Black
DT1267BLK



Cohesion Trim - Brown
DT1103BW



Driftwood and River Rock Accessory Package - 50"
LF50DWS-KIT

Dimensions

FRONT

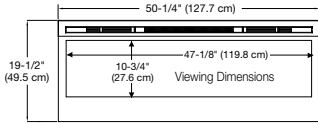

TOP

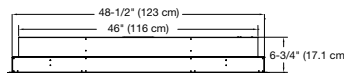

SIDE

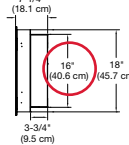

Installation - 3 Mounting Options

ON WALL

Must mount to a minimum of three (3) wall studs

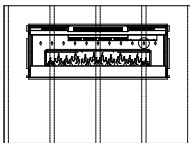

PARTIAL RECESSED

2 X 4 Framing
Framing dimensions:
46-1/2" (118.1 cm) W
x 16-1/2" (42 cm) H

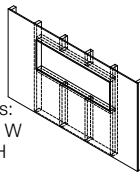

FULLY RECESSED

2 X 8 Framing
Framing dimensions:
49" (124.5 cm) W x
18-1/2" (47 cm) H

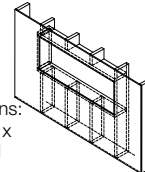

120 Volts | 1,230 Watts | 4,198 BTU

Model #	Description	Lbs / Kg	UPC	Wty. ¹	Carton Dimensions (WxHxD)		Cube	
					Inches	cm	ft ³	m ³
BLF50	Wall-mount fireplace	75 / 34.1	781052 061149	2 yr.	55 x 13 x 23-1/4	139.7 x 33.0 x 58.9	9.6	0.3
DT1267BLK	Cohesion Trim - Black	51 / 23.1	781052 080355	1 yr.	64-7/8 x 26-1/4 x 8-3/4	164.8 x 66.8 x 22.1	8.6	0.24
DT1103BW	Cohesion Trim - Burnished Walnut	51 / 23.1	781052 070929	1 yr.	64-7/8 x 26-1/4 x 8-3/4	164.8 x 66.8 x 22.1	8.6	0.24
LF50DWS-KIT	50" Driftwood & River Rock Accessory Package	7 / 3.17	781052 102842		34-1/4 x 5-7/8 x 8-1/8	87.2 x 14.98 x 20.6		

Specifications, finishes and dimensions are subject to change. ¹Limited warranty. ©2018 Glen Dimplex Americas

SE-001-R03-0081018

Features

- The Original Dimplex Flame Effect™**
A blend of technology, artistry and craftsmanship that sets the standard for realism.
- Media Bed**
Tumbled glass ember bed pieces that are colored and silvered on one side for an alluring effect.
- Supplemental Heat**
Includes a powerful fan-forced heater designed to keep the rooms you spend the most time in warm and comfortable.
- Viewing Area**
Enjoy the panoramic flame through the industry's largest viewing area.
- Remote**
Includes a convenient remote control.
- All-season Flames**
Enjoy the unique charm of a fireplace 365 days a year using the flames without the heat.
- Cool-touch Glass**
Glass remains cool making it safe for children and pets in any location.
- Economical**
Economical to operate costing only pennies per hour.*
- Low Carbon Footprint**
The most sustainable fireplace option; no emissions and 100% efficient.
- Reduces Liability**
Ideal for public spaces in commercial installations; meets the strictest building codes.
- Seamless Installation**
Can be recessed with direct-wire for a seamless look, or simply hung on the wall.
- Quick Assembly**
Sets up in minutes with step-by-step assembly instructions allowing you more time to enjoy your fireplace.

* Based on national average residential electricity rate. Rates vary.